

S327 Precision Cleaver Operating Instructions

- Please read this entire manual prior to using the S327 Precision Cleaver.
- This manual must be kept with the S327 Precision Cleaver.

Safety Instructions

This manual contains the complete operating and basic maintenance instructions for the S327 Precision Cleaver.

Please review this manual carefully before using the S327 Precision Cleaver. The following safety instructions must be followed whenever this product is operated, serviced, or repaired. Failure to comply with any of these instructions or with any precaution or warnings contained in this manual is in direct violation of the standards of the design, the manufacturer, and the intended use of the instrument. FURUKAWA ELECTRIC CO., LTD. assumes no liability for the customer's failure to comply with these requirements.

Safety Instructions



CAUTION

Failure to comply with any of the instructions, which are indicated by this symbol, may cause serious injury or damage to the machine.



ATTENTION

Failure to comply with any of the instructions, which are indicated by this symbol, may cause the device to function improperly and degrade the performance.

Please contact FURUKAWA ELECTRIC CO., LTD. with any questions relating to the description of this manual.

In no case will FURUKAWA ELECTRIC CO., LTD. be liable to the buyer, for any consequential or indirect damage which is caused by product failure, malfunction, or any other problem.



CAUTION

- Avoid soaking the S327 with water. Doing so may cause malfunction.
- This product is a precision machine. Do not drop, throw, or handle it roughly. Doing so may cause machine's malfunction.
- Do not use in a humid, dirty, or unstable environment. Doing so may cause malfunction.
- Please be cautious when disposing of fibers from the fiber waste bin. Scattered fibers may cause injury.
- The fiber waste bin for loose fiber must be installed into the S327 Precision Cleaver during operation, otherwise there is a risk of loose fibers scattering.



ATTENTION

- Use an appropriate tool when loosening or tightening the set screw to fix the single fiber adapter to the unit and gently tighten the screw.
- Please clean the fiber with alcohol after stripping the coating material before setting it on to S327 Precision Cleaver.
- Do not use acetone or other organic solvents to clean the rubber.
- Do not use lubricants for maintenance of this product.
- Do not use organic solvent such as acetone to clean the rubber pads.

1. Standard Components

Parts Name	Parts No.	Qty
S327 Main Body	S327A-01	1
Single Fiber Adapter	S327X-18	1
Waste Bin	S327X-12	1
Carrying Case	S327X-17	1
Hexagonal Wrench	S327X-16	2
Operating Instructions	FTS-B616	1

2. Optional Components

Parts Name	Parts No.	Qty
Blade Exchange Set	S327X-24	1
Single Fiber Adapter	S327X-18	1
Carrying Case	S327X-17	1
Waste Bin	S327X-12	1

3. External Description

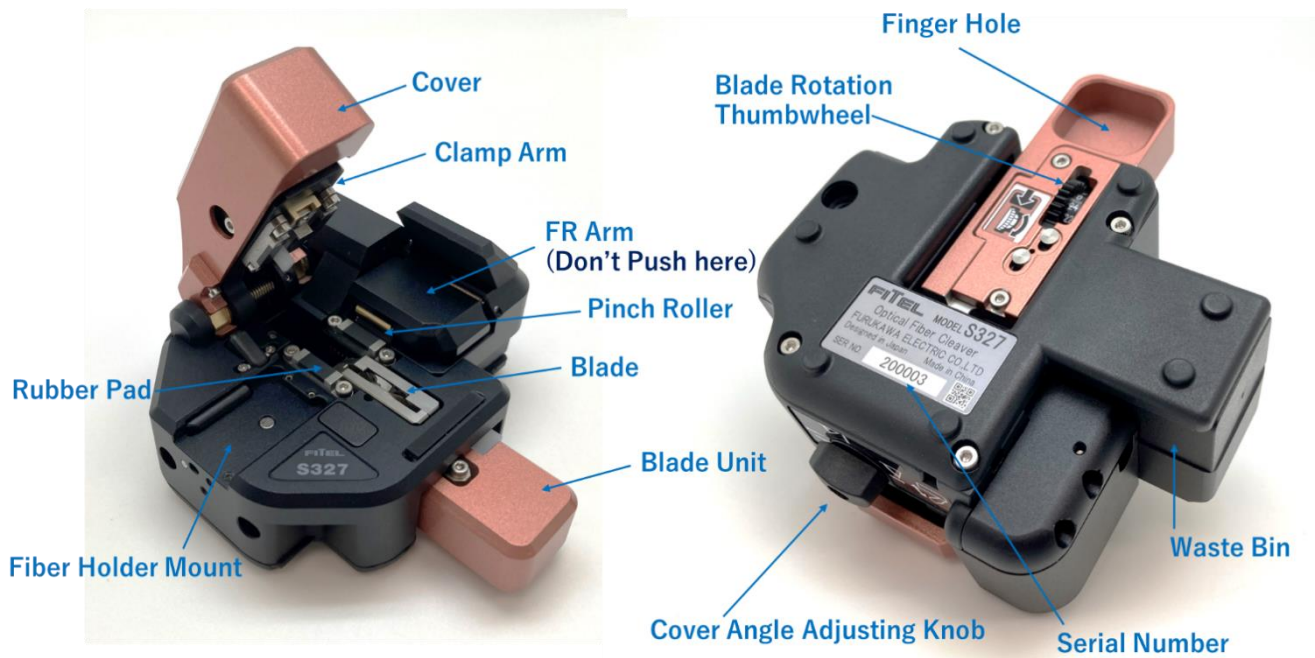

4. Specifications

Applicable Fiber	Silica
Fiber Count	Single Fiber
	Ribbon Fiber (250mm) ; 2~12 fiber ribbon (200mm) ; 2~16 fiber ribbon
Clad Diameter	125 μ m
Coating Diameter	Single Fiber ; 0.20~3.0 mm
	Ribbon Fiber ; 0.20~0.40mm \times 0.25mm pitch 0.20~0.40mm \times 0.20mm pitch
Cleave Length	Single Fiber ; 3~16 mm (Used Single Fiber Adapter)
	Tape ; 10 mm (Used Fiber holder)
Cutting Blade Life	65,000 fiber (2,500 fiber per cutting blade position) ※0.2 mm pitch ribbon fiber decrease of cleaves.
Dimension	88W \times 93D \times 54H mm (Closed for Carrying)
Weight	320 g
Environmental	Operating Temperature ; -10°C ~ +50°C
	Storage Temperature ; -40°C ~ +60°C
	Humidity(Non Condensing) ; ~ 95%

5. Operating instructions

5.1. Unlock cover of Clamp Arm

The Cover of Clamp Arm should be locked during transportation. Unlock the Cover prior to use and select appropriate opening angle. Semi-Open or Fully Open.

- ① Press the Cover down.
- ② Turn the knob to appropriate position.

⚠ATTENTION

- Secure the Cover in the closed position during transportation. If the knob is in the halfway position, the Cover may open.
- Do not push the open FR Arm during use or storage. Components may be damaged, preventing normal disconnection.

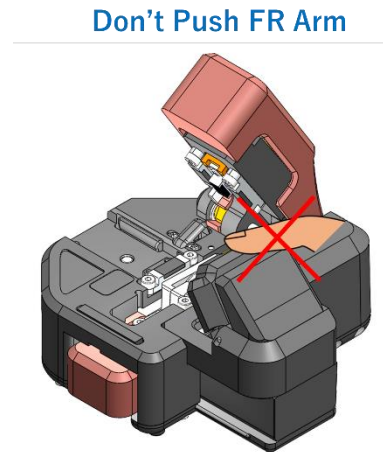
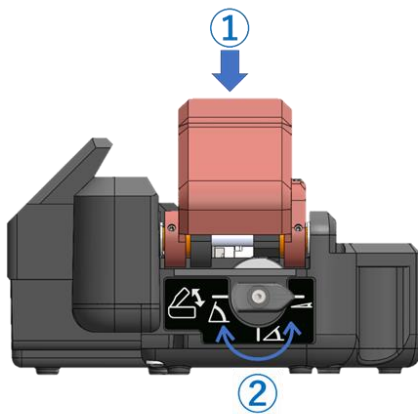

Full Open Should be changed to "Fully Open", change to Semi-open for In-hand use Close for ... must be changed to "Closed for carrying"

Full open
for desk-top use

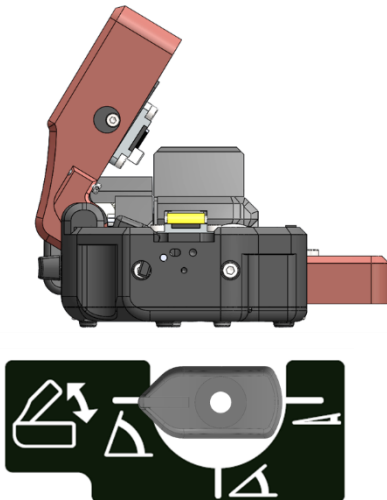

Semi open
for palm-top use

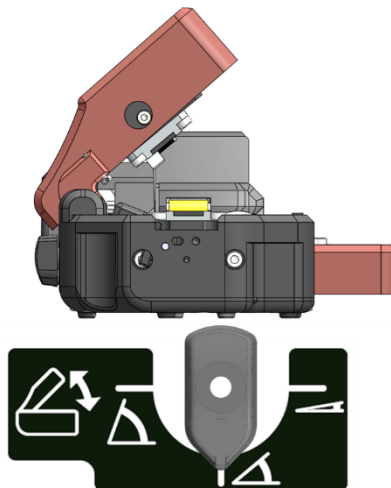

Close
for carrying

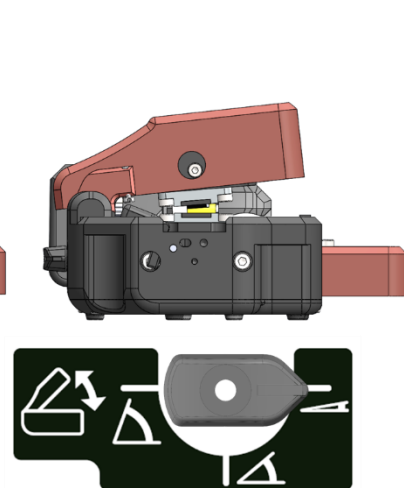

5.2. Cleaving fiber

- ① Push the Blade Unit to the back until it latches.
- ② Set a prepared fiber (stripped and cleaned) across cleaving area with fiber end inserted into the Waste Bin.
Ensure that the stripped fiber is long enough to reach the Pinch Roller. Put fiber to the appropriate v-groove on the single fiber adapter, depending on the coating diameter of optical fiber.
In case of ribbon fiber cleaving, please use the ribbon fiber holder (Optional parts).
When using ribbon fiber, check that the fibers are aligned horizontally and no fibers are overlapping with each other.

⚠ATTENTION

Fibers should be set at the appropriate length.
If it is too short to reach the Pinch Roller, the fiber shard may not be collected in the waste bin.
If it is too long, the fiber may bend and not be cut properly.

- ③ Press the Cover of Clamp Arm until the Blade Unit starts to slide.

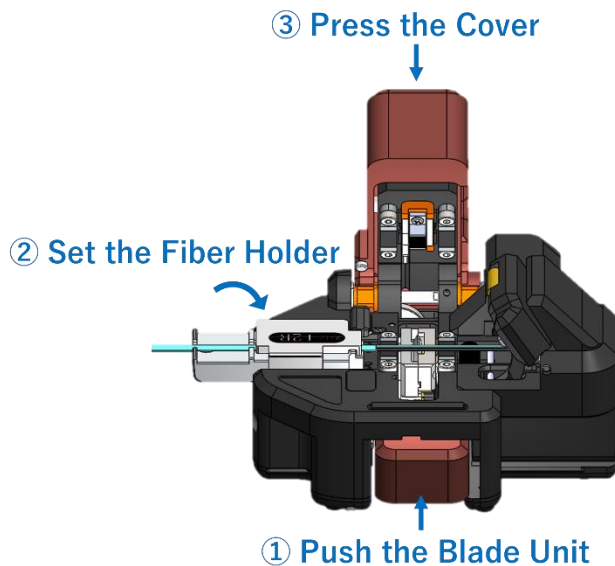

Single Fiber Adapter

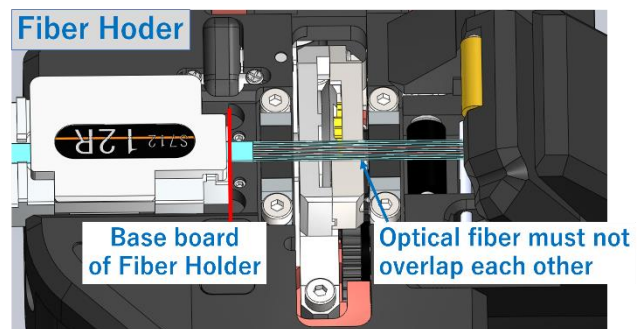
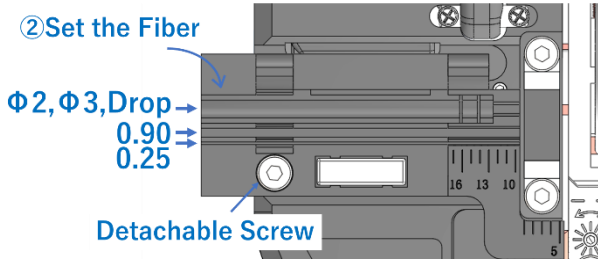

Fiber Holder

5.3. Disposing of waste fiber

- ① Pull down the edge of Waste Bin.
- ② Slide out the Waste Bin.

⚠ATTENTION

Fibers may pop out when pulling out the Waste bin.
Avoid getting them in your eyes.

Do this action on top of fiber disposal bin, as fiber waste that doesn't fit into the bin may spill out.

- ① Pull down the edge of the waste bin.
- ② Slide out the waste bin

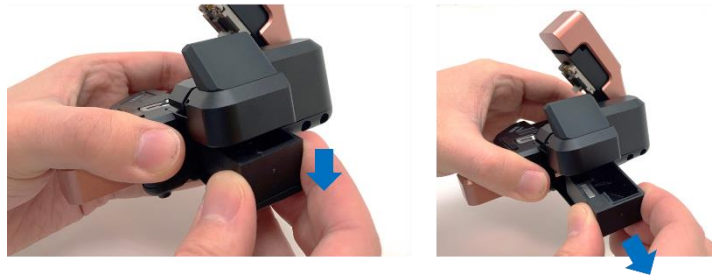

5.4. Blade rotation

- ① Slide out the Waste Bin (Refer to 5.4)
- ② Push in the Blade Unit until it latches then press more firmly until the Blade Rotation Thumbwheel is unlocked.
- ③ Rotate the Thumbwheel to increment the blade position by 1.
If you accidentally incremented too much, turn the Thumbwheel through one full turn.

- ① Slide out the Waste Bin
- ② Push in the blade unit to the end.
- ③ Rotate the dial.

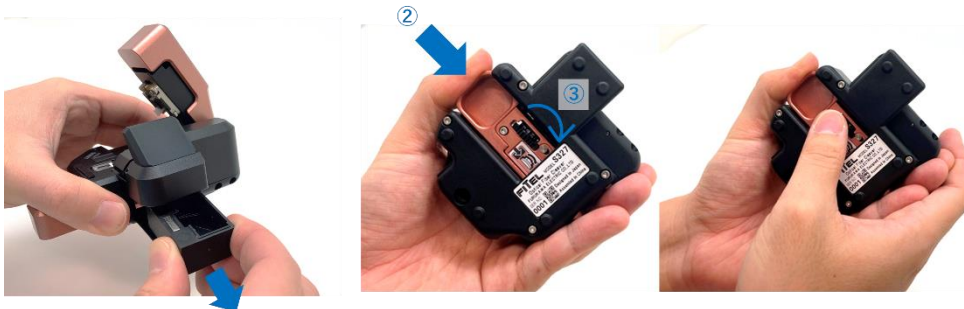

⚠ATTENTION

Don't touch the FR arm while working on ②③.

Please take care not to tilt S327 Precision Cleaver too much, as fiber will spill out of the Waste bin.

Take care not to cut your fingers with the Blade.

6. Blade and Pinch Roller Maintenance

When cleaving quality degrades, clean the top of blade and upper and lower clamping pads with a cotton swab with a little ethyl alcohol.

After repeated use, abrasion may form on the rubber of the pinch roller. If fiber waste can't be collected well enough, the pinch roller needs to be replaced. Contact our service center for replacement.

The blade can be replaced by the customer.

Purchase and replace the optional parts; "Blade Exchange Set" (S327X-24).
It does not guarantee End-Face condition or Cutting Blade Life.

If the above does not solve the problem, the function may be temporarily restored by removing the seal (light blue in the diagram below) and adjusting the height of the cutting blade using the attached hexagonal wrench.

It does not guarantee End-Face condition or Cutting Blade Life.

After implementation, contact the service center immediately for repair.

~Raise the height of the Blade~

1. Loosen ② screw
2. Turn ① in the "+" direction of the 1 tick.
3. Tighten ② screws

~Lower the height of the Blade~

1. Turn ① in the "-" direction of the 1 tick.
2. Tighten ② screws
- 3.

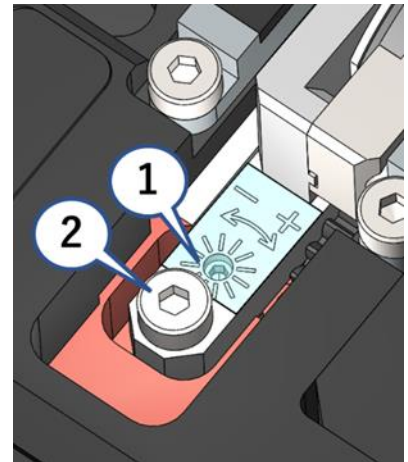

7. Disposal

S327 contains no hazardous substances or recyclable materials. If disposed of, follow your local disposal regulations.

8. Contacts

For sales and service information,
Contact FURUKAWA ELECTRIC CO., LTD.
Or your local representative.

Sales Department:

Furukawa Electric Co., Ltd.

Tokiwabashi Tower, 6-4, Otemachi 2-Chome, Chiyoda-ku, Tokyo, 100-8322,
Japan